

PLOT NO	AREA
01	364.25
02 to 05	341.00
06	537.33
07	122.22
8	133.33
9 to 12	146.66
13	231.11
14	146.66
15	105.41
16	444.44
17	345.73
18	132.29
19	134.37
20	136.11
21	440.00
22	314.52
23	295.07
24	275.44
25	180.00
26	160.00
27 & 28	226.66
29	180.00
30	160.00
31	200.00
32 & 33	160.00
34	170.00
35	151.11
36 & 37	142.22
38 & 39	177.77
40 & 41	142.22
42	130.00
43	114.44
44 & 45	142.22
46	177.77

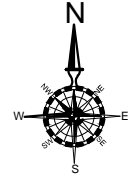
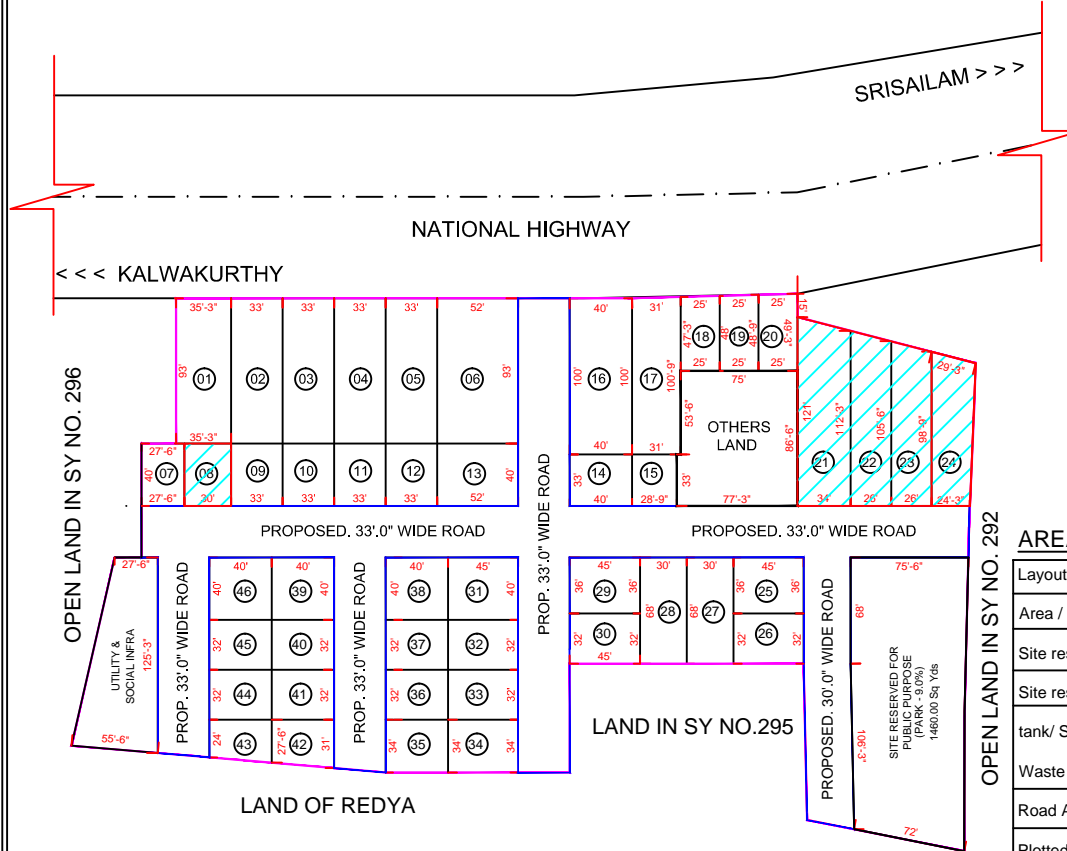

TENTATIVE

LP.NO. 0022/LO/3061/2022

APPLICANT NO :

000220/LO/DTCP/3061/0001/2022

REFERENCE:

LAYOUT BOUNDARY



EXISTING ROADS



PROPOSED ROADS



MORTGAGE AREA



AREA STATEMENT

Layout Extent /	Area 3 Acer 20.09 Gts 16951 Sq. Yds
Area / Area reserved for Open space (Park) (9.05%)	0 Acer 12.13 Gts 1467 Sq. Yds
Site reserved for Social Infrastructure (2.51%)	0 Acer 3.36 Gts 407 Sq. Yds
Site reserved for Utilities such as water reservoir, Septic tank/ Sewerage Treatment Plant, Electric transformer, Solid Waste Management etc., (1%)	0 Acer 1.34 Gts 162 Sq. Yds
Road Area (27.9%)	0 Acer 37.4 Gts 4526 Sq. Yds
Plotted Area (59.54%)	1 Acer 39.81 Gts 9657 Sq. Yds
Mortgage Area (15.05 %)of plotted area (From Plot No.08,21,22,23,24)	0 Acer 12.08 Gts 1462 Sq. Yds
No of plots	46 No's

KALWAKURTHY MUNICIPALITY

PROPOSED LAYOUT PATTERN FOR RESIDENTIAL PLOTS IN SURVEY NOS. 292/P & 295/P

SITUATED AT KALWAKURTHY VILLAGE & MANDAL, NAGAR KURNOOL DIST., T.S.

BELONGS TO : N.DILEEPA CHARY AND OTHERS

*Approved
Layout*
D.T.C.P

Mohammed Miskeen

D.M.Civil, (B.Tech)

Govt. Licensed Land Surveyor

License.No : 1437 CSS&LR

Off: **MUSTAQA BUILDING DESIGNERS**
OPP.M.R.O. OFFICE,JADCHERLA 509301
MAHABUNNAGAR DIST. T.S.

LICENSED SURVEYOR

cell : 970 333 4826
988 575 3454